

BRAUN

Series 7



730s-3

720s-3

Type 5694
Type 5695

www.braun.com/register



Braun Infolines

English	4, 8	(GB)	0800 783 70 10
Français	9, 13	(IRL)	1 800 509 448
Español	14, 18	(CH)	08 44 - 88 40 10
Português	19, 23	(F)	0 800 944 802
Italiano	24, 28	(B)	0 800 14 592
Nederlands	29, 33	(E)	901 11 61 84
Dansk	34, 38	(P)	808 20 00 33
Norsk	39, 43	(I)	(02) 6 67 86 23
Svenska	44, 48	(NL)	0 800-445 53 88
Suomi	49, 53	(DK)	70 15 00 13
Türkçe	54, 58	(N)	22 63 00 93
Ελληνικά	59, 63	(S)	020 - 21 33 21
		(FIN)	020 377 877
		(TR)	0 800 261 63 65
		(HK)	852-25249377 (Audio Supplies Company Ltd.)

www.service.braun.com

Braun GmbH
Frankfurter Straße 145
61476 Kronberg/Germany

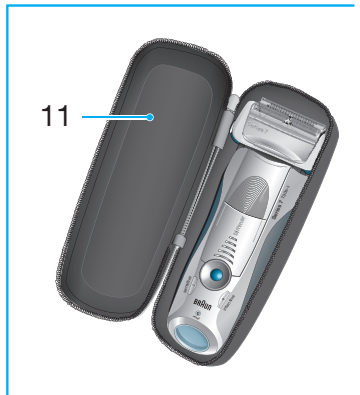
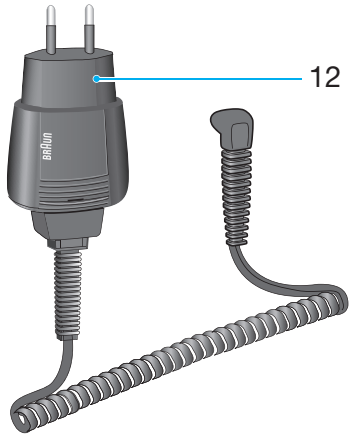
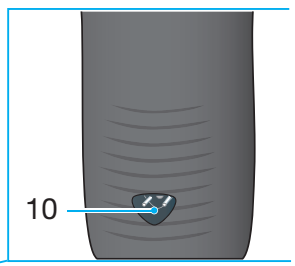
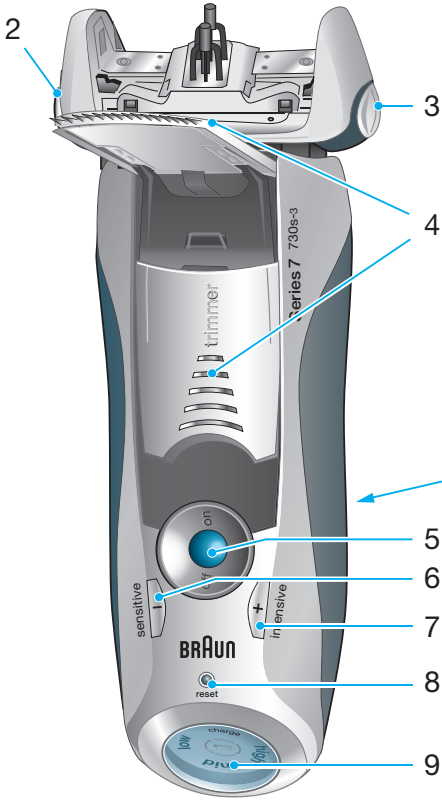

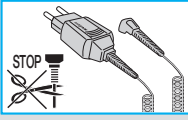

Our products are designed to meet the highest standards of quality, functionality and design. We hope you enjoy your new Braun Shaver.

Warning

Your shaver is provided with a special cord set, which has an integrated Safety Extra Low Voltage power supply. Do not exchange or tamper with any part of it, otherwise there is risk of electric shock.

This appliance is not intended for use by children or persons with reduced physical, sensory or mental capabilities, unless they are given supervision by a person responsible for their safety. In general, we recommend that you keep the appliance out of reach of children. Children should be supervised to ensure that they do not play with the appliance.

Description

- ① Foil & Cutter cassette
- ② Cassette release button
- ③ Shaver head «lock» switch
- ④ Pop-out long hair trimmer
- ⑤ On/off switch
- ⑥ «sensitive» (-) setting button
- ⑦ «intensive» (+) setting button
- ⑧ Reset button
- ⑨ Shaver display
- ⑩ Shaver power socket
- ⑪ Travel case
- ⑫ Special cord set

Charging

The best environmental temperature for charging is between 5 °C and 35 °C.

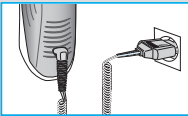

- Using the special cord set ⑫, connect the shaver to an electrical outlet with the motor switched off and charge it for at least one hour.
- A full charge provides up to 50 minutes of cordless shaving time. This may vary according to your beard growth.
- If the rechargeable battery has run out of power (discharged), you may also shave by connecting the shaver to an electrical outlet via the special cord set.

Shaver display ⑨

The green indicator flashes when the shaver is being charged or when in use.

When the battery is fully charged, the charge segment «high» (720) / «high» «mid» (730) will light up continuously provided that the shaver is switched on or connected to an electrical outlet.

The red «low» indicator flashes when the battery capacity has dropped below 20%, provided the shaver is switched on. The remaining capacity will then be sufficient for 2 to 3 shaves.

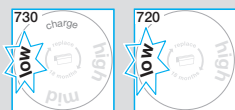
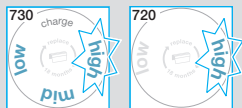

Personalizing your shaver

Personalizing your shaver

With the «sensitive» ⑥ and «intensive» ⑦ buttons you can choose the best setting for shaving different areas of your face and as per your specific needs. The different settings are indicated by the pilot light incorporated in the on/off switch ⑤:

- «Intensive» = dark blue (powerful shave)
- «Normal» = light blue
- «Sensitive» = white (for a thorough comfortable shave in sensitive areas of your face such as neck)

For a thorough and fast shave we recommend the «intensive» setting.

Pressing the «+» or «-» button activates your preferred setting. When switching on next time, the last used setting will be activated.

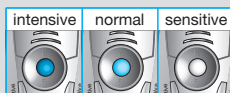

How to use

Press the on/off switch ⑤ to operate the shaver:

- The pivoting shaver head and floating foils automatically adjust to every contour of your face.
- To shave hard to reach areas (e.g. under the nose) slide the shaver head «lock» switch ③ to the back position to lock the pivoting head at an angle.
- To trim sideburns, moustache or beard, slide the pop-out long hair trimmer ④ upwards.

Tips for the perfect shave

For best shaving results, Braun recommends you to follow 3 simple steps:

1. Always shave before washing your face.
2. At all times, hold the shaver at right angles (90°) to your skin.
3. Stretch your skin and shave against the direction of your beard growth.

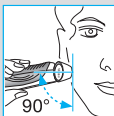
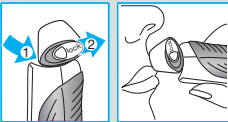
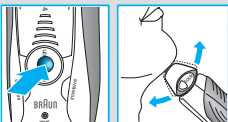

Cleaning



The shaver head is suitable for cleaning under running tap water.

Warning: Detach the shaver from the power supply before cleaning the shaver head in water.

Regular cleaning ensures better shaving performance. Rinsing the shaving head under running water after each shave is an easy and fast way to keep it clean:

- Switch the shaver on (cordless) and rinse the shaving head under hot running water. You may use liquid soap without abrasive substances. Rinse off all foam and let the shaver run for a few more seconds.
- Next, switch off the shaver, press the release button ② to remove the Foil & Cutter cassette ① and let it dry.
- If you regularly clean the shaver under water, then once a week apply a drop of light machine oil on top of the Foil & Cutter cassette.

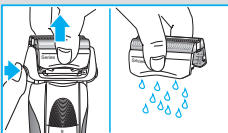
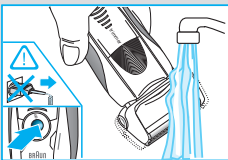

Alternatively, you may clean the shaver using the brush provided:

- Switch off the shaver. Remove the Foil & Cutter cassette ① and tap it out on a flat surface. Using the brush, clean the inner area of the pivoting head. However, do not clean the foil and cutter cassette with the brush as this may damage it.

Keeping your shaver in top shape

Replacing the Foil & Cutter cassette / reset

To maintain 100% shaving performance, replace the Foil & Cutter cassette ①, when the replacement symbol lights up on the shaver display ⑨ (after about 18 months) or when cassette is worn

The replacement symbol will remind you during the next 7 shaves to replace the Foil & Cutter cassette. Then the shaver will automatically reset the display.

After you have replaced the Foil & Cutter cassette, use a ball-pen to push the reset button ⑧ for at least 3 seconds to reset the counter. While doing so, the replacement light blinks and goes off when the reset is complete. The manual reset can be done at any time.

Accessories

Available at your dealer or Braun Service Centres:

- **Foil & Cutter cassette 70S**

Environmental notice

This product contains rechargeable batteries. In the interest of protecting the environment, please do not dispose of the product in household waste at the end of its useful life. Disposal can take place at a Braun Service Centre or at appropriate collection points provided in your country.



Subject to change without notice.

For electric specifications, see printing on the special cord set.

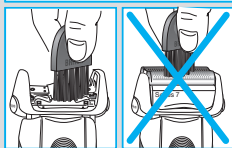
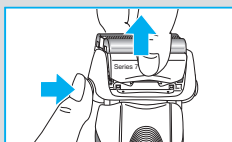

Guarantee

We grant a 2 year guarantee on the product commencing on the date of purchase. Within the guarantee period we will eliminate any defects in the appliance resulting from faults in materials or workmanship, free of charge either by repairing or replacing the complete appliance at our discretion.

This guarantee extends to every country where this appliance is supplied by Braun or its appointed distributor.

This guarantee does not cover: damage due to improper use, normal wear and tear (e.g. shaver foil or cutter block) as well as defects that have a negligible effect on the value or operation of the appliance. The guarantee becomes void if repairs are undertaken by unauthorised persons and if original Braun parts are not used.

To obtain service within the guarantee period, hand in or send the complete appliance with your sales receipt to an authorised Braun Customer Service Centre (address information available online at www.service.braun.com).

For UK only:

This guarantee in no way affects your rights under statutory law.